



PHAROS GPS Phone 600 Series



Hardware Quick Start Guide

Travel with ease and confidence

Pharos GPS Phone 600 Series **Quick Start Guide**

GPRS / EDGE Settings for AT&T / Cingular

1. Tap  Start, Settings > Connections tab > Connections > Tasks tab.

Tap Add a new modem connection.

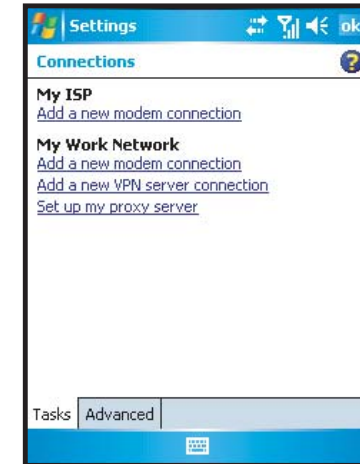

2. Enter a new connection name (i.e. Cingular GPRS).

Select **Cellular Line (GPRS)**.

Tap **Next**.

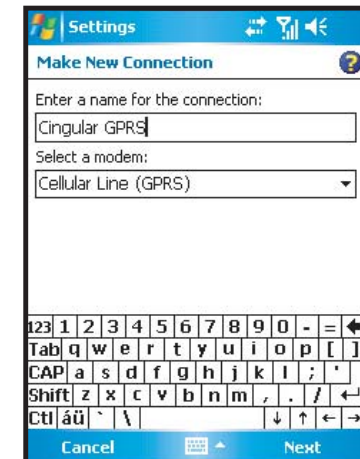

GPRS / EDGE Settings for AT&T / Cingular cont'd

3. Enter Access point name: **wap.cingular**.

Tap **Next**.

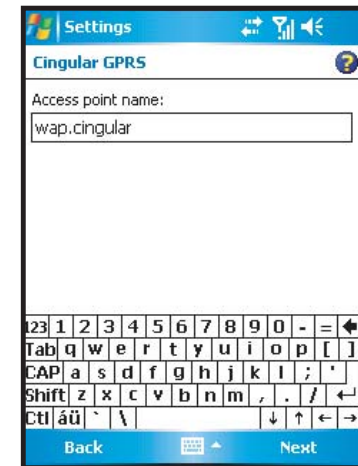

4. Tap **Finish**.

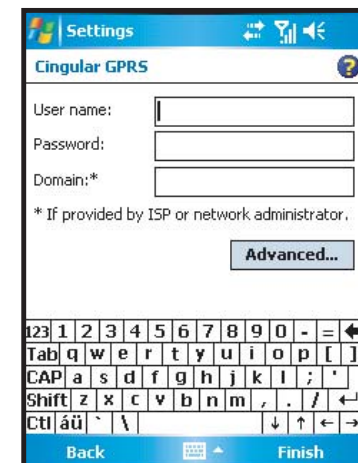

GPRS / EDGE Settings for T-Mobile

1. Tap  Start, Settings > Connections tab > Connections > Tasks tab.

Tap Add a new modem connection.

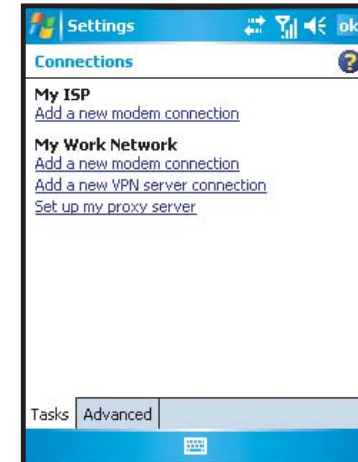

2. Enter a new connection name (i.e. T-Mobile GPRS).

Select **Cellular Line (GPRS)**.

Tap **Next**.

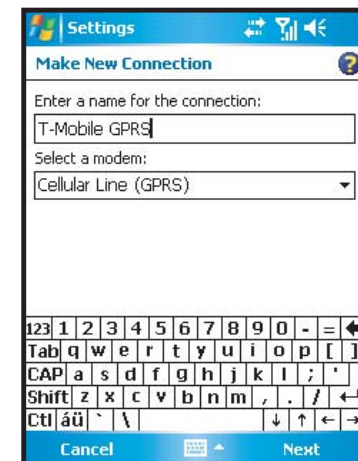

GPRS / EDGE Settings for T-Mobile cont'd

3. Enter Access point name: **wap.voicestream.com**.

Tap **Next**.

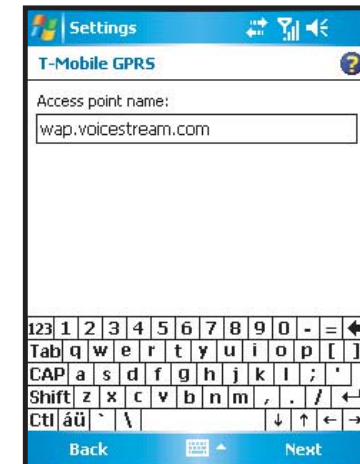

4. Tap **Finish**.

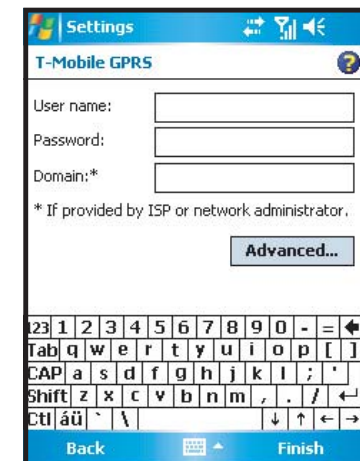

What's in the box?

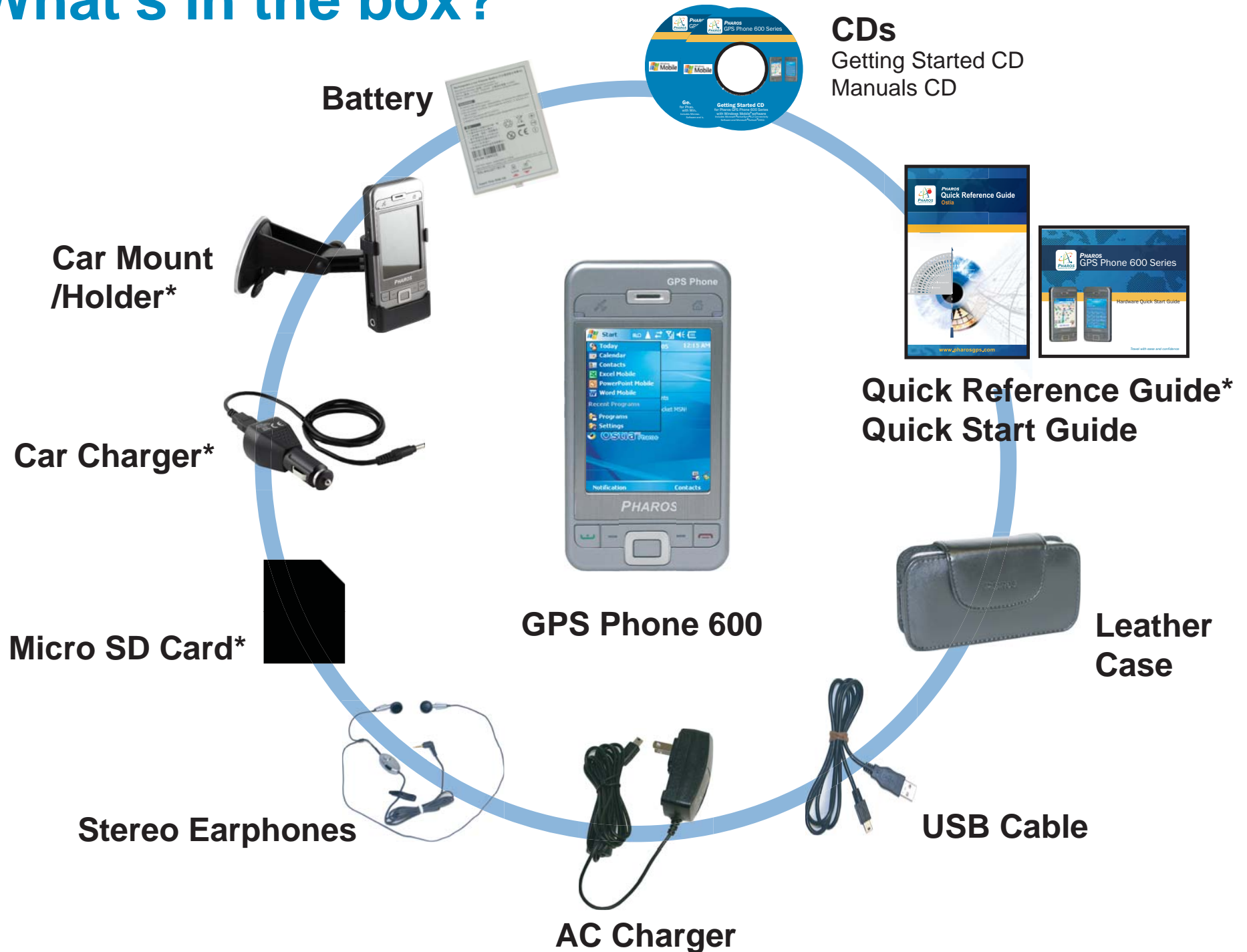

*These items and Ostia navigation software are not included in the 600e package.

Getting to Know Your GPS Phone 600

Speaker

Press for GPS Navigation*

Bluetooth / WLAN / GPS LED Indicator

Start & Status Icons

Tap Start to select Programs, Settings, and Help. Tap Status icon to view details or change options.

Volume Adjust

Screen Orientation / Record Key

Left Soft-Key

Zoom-in Key in Ostia.

Talk Key

Dials; answers a call; puts a call on hold (call waiting); switches active call and call on hold

Headset Jack

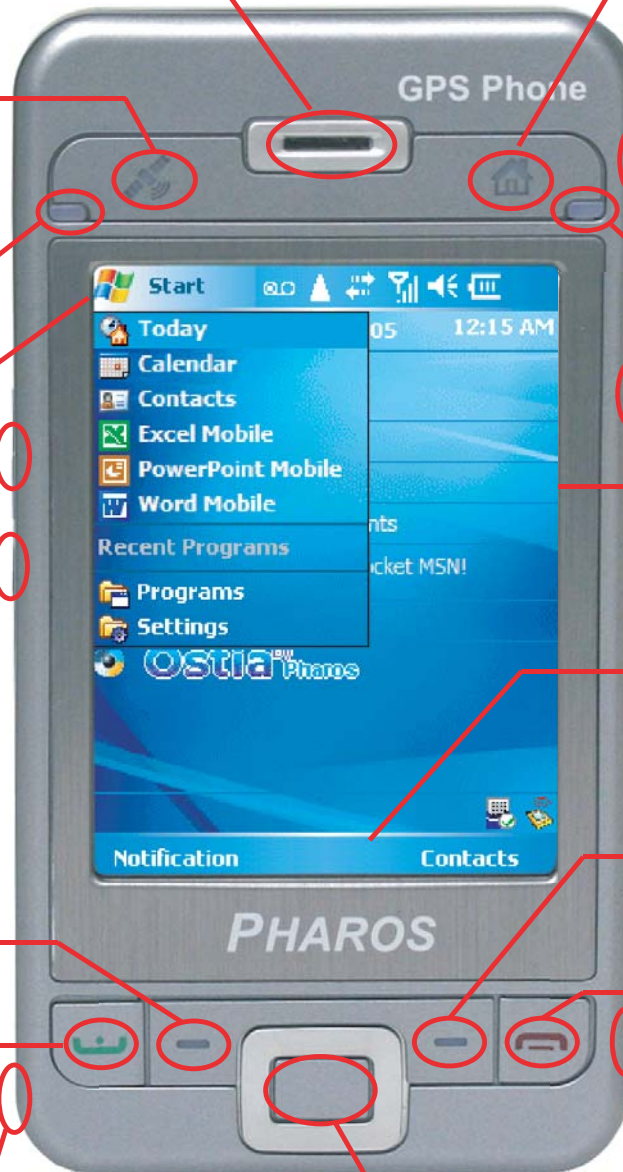

Today

Returns to the Today screen

Power Button

Power / Cell Phone Active LED Indicator

Reset Button

Today Screen

Provides information for the day. Tap an item to view or edit details.

Command Bar

Provides menus and buttons to perform tasks in programs.

Right Soft-Key

Zoom-out Key in Ostia.

End / Hang Up

Ends calls.

Camera Shutter

Navigator Keypad

Carries out an action similar to pressing **ENTER** on a keyboard.

*Not applicable to GPS Phone 600e

4. Default Settings

Tap  Start > Programs > Utilities > Default Settings.

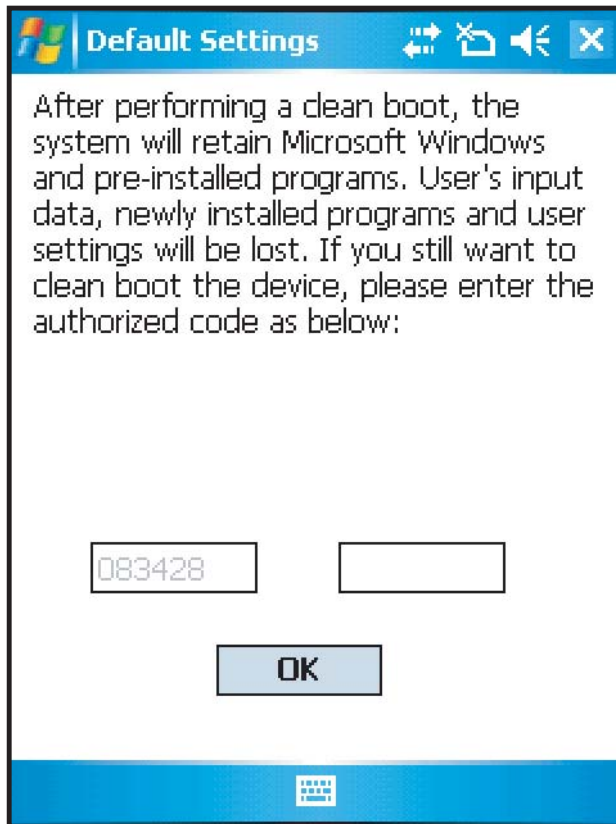

1. If this application is inadvertently accessed, please select the  to the upper right of the screen to exit, the system will not be affected.
2. If you are certain that you wish to perform this action, please select the data input block on the right and enter the authorized code in the block to the left. Tap the OK button when finished.

Result:

This will retain only the Microsoft Windows and factory pre-installed applications. Other settings such as user's input data, newly installed programs, and user custom settings will all be cleared.

Charging the Battery



Insert the main battery

Follow the steps 1 and 2 shown to the left.

Caution:

Make sure the battery is locked before you use the GPS Phone 600.



Unlock



Lock

Connecting the USB Cable or AC Charger with the GPS Phone 600



GPS Phone 600

AC Charger

USB Cable

PC or Notebook

Home or Office Configuration

Connecting the Car Charger to the Car Mount



Vehicle Configuration

Important Notes When Using the GPS

When using this device, please use with matching car mount. Affix the device securely to the car mount. Please be aware that the areas shown below can be dangerous areas to place the device.



1. Do not place where it will obstruct the driver's vision
2. Do not place over air bag
3. Do not place where it can not be securely attached
4. Do not place in path of activated airbag

Turning on and Customizing Your GPS Phone 600

1. Turn on your GPS Phone 600

Disconnect the AC charger from the Mini USB port and press the **Power** button.

2. Set the time and date

Tap  Start > Settings > System > Clock & Alarms.

Adjust the time zone as needed.

Tap hours, minutes, seconds, or date and use the arrows to adjust the number.

Tap OK to save your changes.

Power Button



Securing Your GPS Phone 600

Secure your phone

Use a personal identification number (PIN) to protect your phone from unauthorized use.

Your first PIN will be given to you by your mobile operator.

From the Phone keypad, tap Menu > Options, then tap the Phone tab.

Select **Require PIN when phone is used**.

Secure your information

User a password to protect the information on your GPS Phone 600.

Tap  Start > Settings, and then tap Lock.

Use a strong password if your GPS Phone 600 is configured to connect to a network.

Select how long your GPS Phone 600 must be turned off before the password is required to use the device.

Tap the **Hint** tap to provide a hint in case you forget your password.

Status Indicators

Status indicators are displayed at the top of the screen.

 Active connection to computer

 ActiveSync is synchronizing

 Speaker is on

 Speaker is off or in mute position

 GPRS available

 GPRS in use

 EDGE available

 EDGE in use

 WLAN active

 WLAN data calling

 WLAN in use

 New instant message

 PPT slide show

 SIM Card unavailable

 Phone is powered on

 Network is searching or unavailable

 Phone connection unavailable or network error

 Phone is powered off

 Signal strength indicator for phone function

 Missed call

 Call Forwarding active

 Calls are forwarded

 Roaming

 New e-mail SMS



 Voice mail

Making a Phone Call

1. Turn on your GPS Phone 600

Disconnect the AC charger from the Mini USB port and press the **Power** button.

2. Make a phone call

Press . On the phone key pad, enter the number you want to call, and tap Talk or press .

To delete a digit, tap .

Tap and hold  to delete all digits.

To end the call, tap End or press .

3. Turn off your GPS Phone 600

Press the **Power** button.

Power Button



Making and Receiving Calls

Make a call:

Press  to bring up the dialer screen. Enter the phone number, and tap **Talk** or press .



Receive a call:

Press  or tap **Talk** on the dialer screen.

End a call:

Press  or tap **End** on the dialer screen.

Make an emergency call:

Press . Dial the emergency number appropriate for your location (even if the GPS Phone 600 is locked), and press .

Silence the phone ring for an incoming call:

Press the **Volume** control.

Using speed dial

Creating a speed dial for a phone number:

Tap Speed Dial > Menu > New. The contact list will open, select a contact. Select the speed dial number to associate with the phone number, and tap OK.

Use a speed dial number:

Tap Speed Dial, then tap the **speed dial** number.

Enabling the Speakerphone Mode

Enabling the speakerphone:

On an incoming phone call, tap **Answer** to receive the call, then tap **Speaker on** to turn on the speakerphone.

On an outgoing phone call, tap **Speaker on** to turn on the speakerphone.

Disabling the speakerphone:

Tap **Speaker off** to turn off the speakerphone.

Synchronizing Outlook Information

If you use Outlook on a desktop PC, you can synchronize e-mail, contacts, calendar, and more with your GPS Phone 600.

1. Install Active Sync on the desktop PC

Do not connect your desktop PC and your GPS Phone 600 with the USB cable until after you have installed ActiveSync.

Insert the Getting Started CD into the CD drive or your desktop PC.

On the screen that appears, click the green arrow, click **Start Here**, then follow the directions.

2. Set up a partnership

Connect your desktop PC and GPS Phone 600 with the USB cable, turn on the GPS Phone 600. When your desktop PC detects the GPS Phone 600, it will start the ActiveSync New Partnership Wizard. Follow the instructions on the screen.

After you finish using the wizard, your data will begin to synchronize between your desktop PC and the GPS Phone 600.

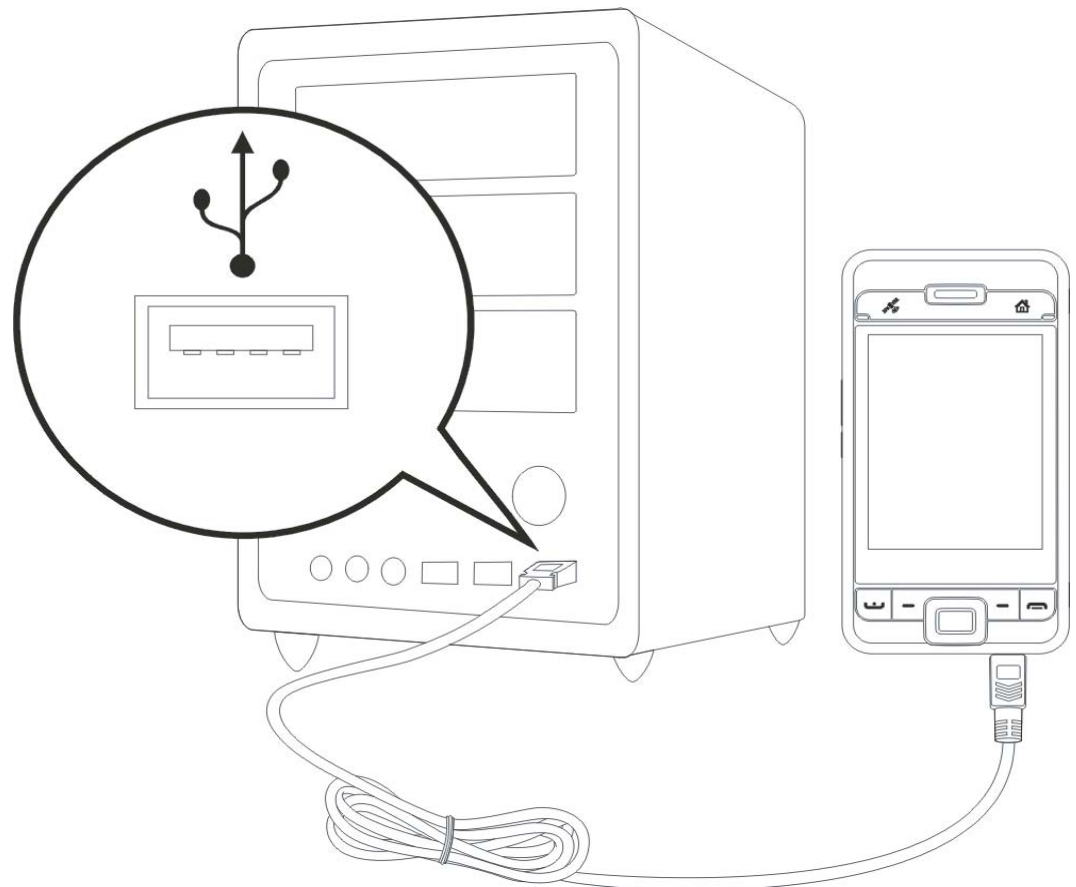

Setting Up an E-mail Account or Using a Web-based E-mail

If you have an e-mail account with an Internet service provider, you can send and receive e-mail from your GPS Phone 600.

If you can access your e-mail account from a webpage on your desktop PC, you can also access this account on your GPS Phone 600. For **AT&T / Cingular**, use **cwmx.com** as the outgoing mail server.

Set up e-mail on your GPS Phone 600

Tap  Start > Messaging.

In Messaging, tap Menu > Tools > New Account.

Follow the instructions on the screen.

Using a Web-based e-mail

Tap  Start > Internet Explorer.

Enter the Web address of your e-mail service, e.g. www.hotmail.com, and tap the green arrow next to the address field. Set up a Web-based e-mail account.

Server type, incoming and outgoing mail server names, user name, password.

Taking a Picture or Video and Sending It via E-mail



Take a picture

Tap  Start > Programs > Multimedia > Camera.

The camera screen will display what the lens is capturing.

Press the Camera Shutter button, the lower left side of the GPS Phone 600, to take a picture.

Send a picture via e-mail

Tap  Start > Messaging > New.

Tap To, Cc or Bcc to open the Contacts screen. As long as you have set up Contacts before hand, you can simply tap to select a contact.

Enter the e-mail or text message address of the recipient, the subject, and your message.

To add a picture, tap Menu > Insert, and select the file you want to attach.

View your pictures & videos

Tap Start > Programs > Pictures & Videos.

Connecting to the Internet by GPRS / EDGE

You can use GPRS / EDGE wireless network connection.

Make sure that your telecom company provides this service and apply for a SIM with GPRS / EDGE function.



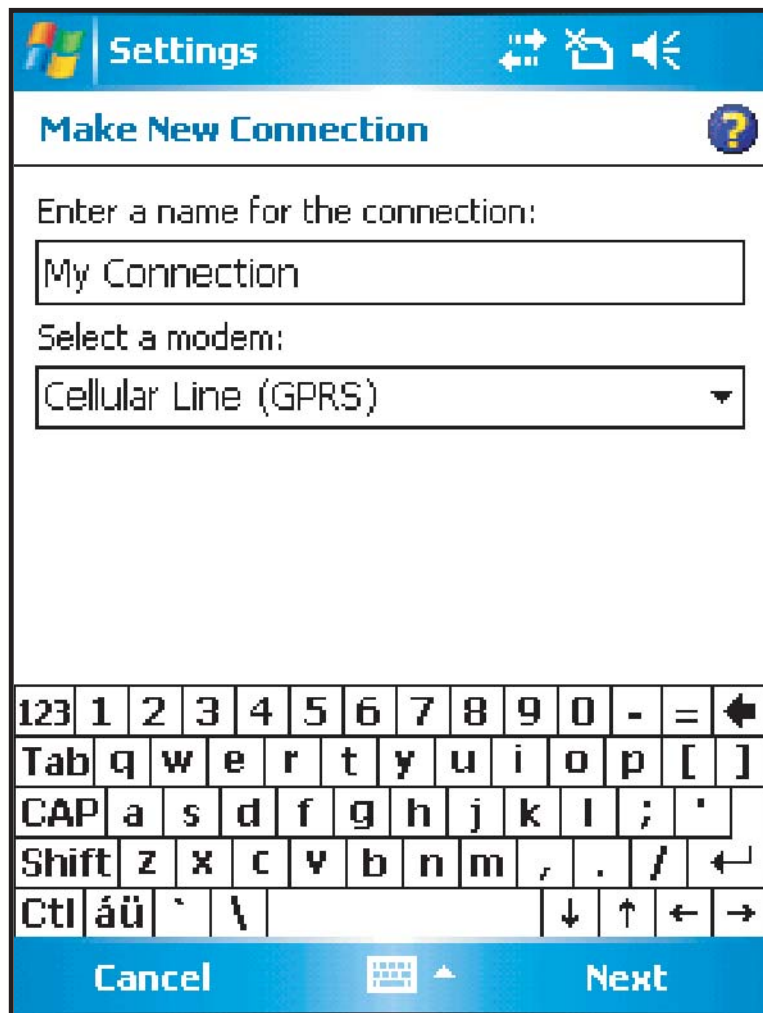





Tap  Start > Settings, tap the Connections tab > Connections > tap the Tasks tab.



1. On the screen of the Tasks tab, tap **Add a new modem connection** below **My ISP**.
2. The Make New Connection screen will appear as shown to the left.
 - Under **Enter a name for the connection**, Input a new connection name for convenience in making connections in the future.
 - Under **Select a modem**, tap **Cellular Line (GPRS)**, then tap Next.
3. Input the Access point name, provided by your telecom company and tap Next.
4. Input your personal information such as account number, and tap Finish.

Starting GPRS / EDGE Connection



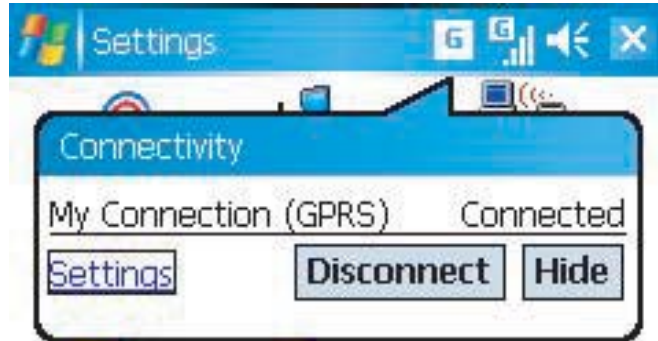

1. Tap  or  at the top of the screen and when a message window appears tap **Turn off flight mode** and input the PIN to turn on the phone. The  icon will change to  while the  icon will change to .
2. Tap , then tap **Settings** to link to **Connections**.
You are ready to connect GPRS / EDGE.
3. Select **Manage existing connections** on the Connections menu. Tap and hold on the newly created connection name, and then select **Connect** to finish the GPRS / EDGE connection.
4. After the connection is established, the  icon will change to .
5. Now you can use the appropriate program to access the Internet and receive or send e-mails.

Disconnecting GPRS / EDGE

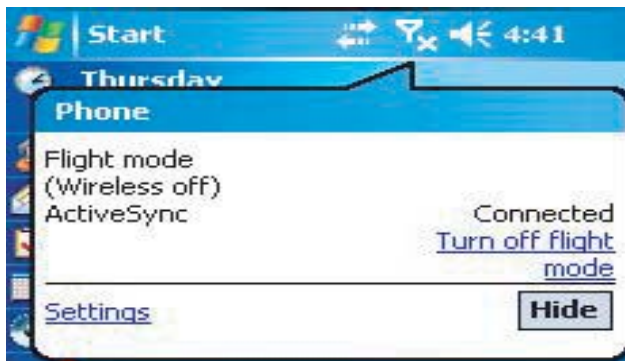

1. Disconnect GPRS / EDGE:
Tap **G** / **E** and the message window appears.
Tap **Disconnect**.



2. Turn off Phone:
Tap  and the message window appears.
Tap **Turn on flight mode**.

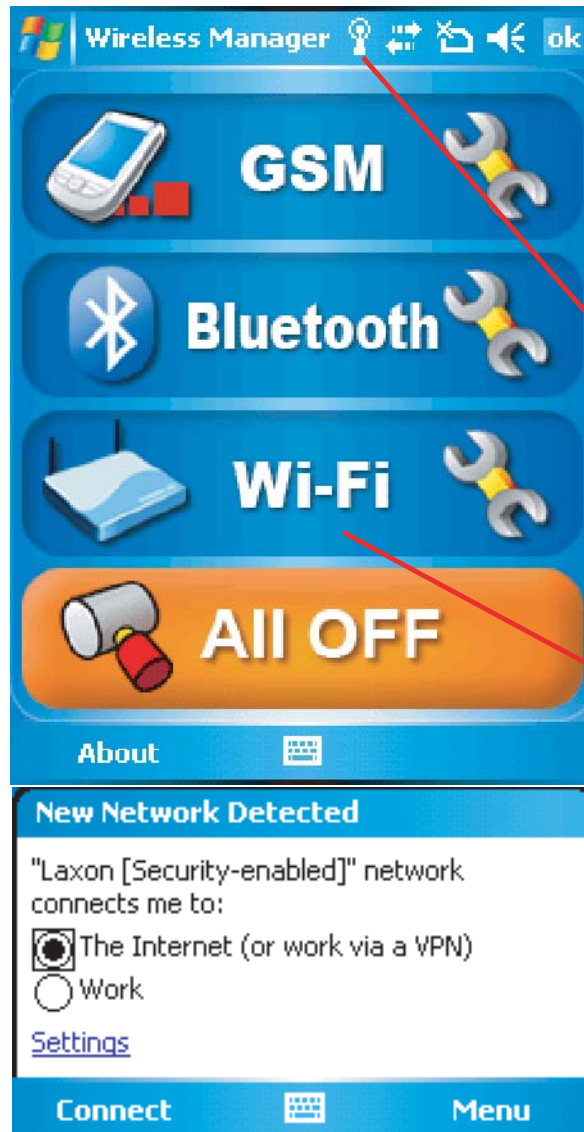

Using WLAN Connection

This section teaches you how to use a WLAN connection. You can use the GPS Phone 600 to browse websites, read or send e-mail, SMS or MSN messages at places where a WLAN is accessible.



You will be able to obtain an IP, DSN, Proxy and other essential information to access a network when you purchase the service, or have permission from the network administrator. For detailed setting information, refer to the User's Manual.

Tap  Start > Programs > Wireless Manager.



1. Your GPS Phone 600 will show the  icon when it detects an available WLAN. This means that your GPS Phone 600 has successfully connected with the Access Point. The LED indicator on the upper corner of the Today screen flashes orange.
2. Tap here to choose the WLAN mode (Active or Inactive). If the  icon appears, the WLAN is inactive.

Select an available WLAN, tap OK, then select **Work**, and tap Connect.

After you enter the settings the first time, your GPS Phone 600 will remember those settings for future access.

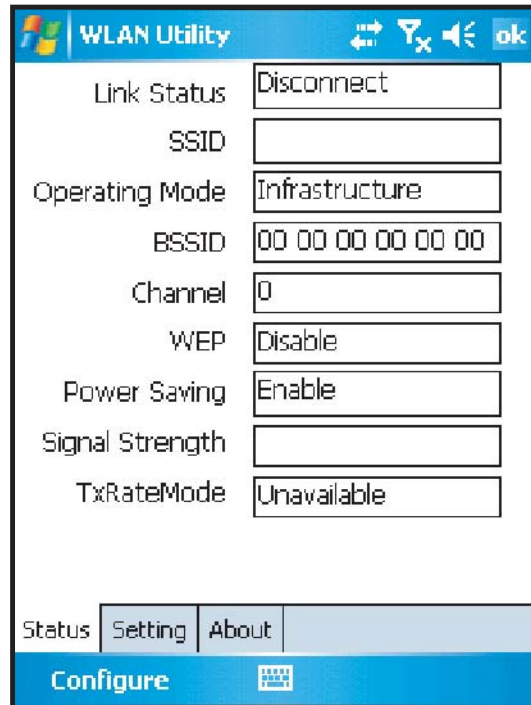
Changing an Available WLAN



If you would like to change to another available WLAN, just tap  Start > Programs > Wireless Manager > tap the  icon on the Wi-Fi tab.

Tap **Configure**.

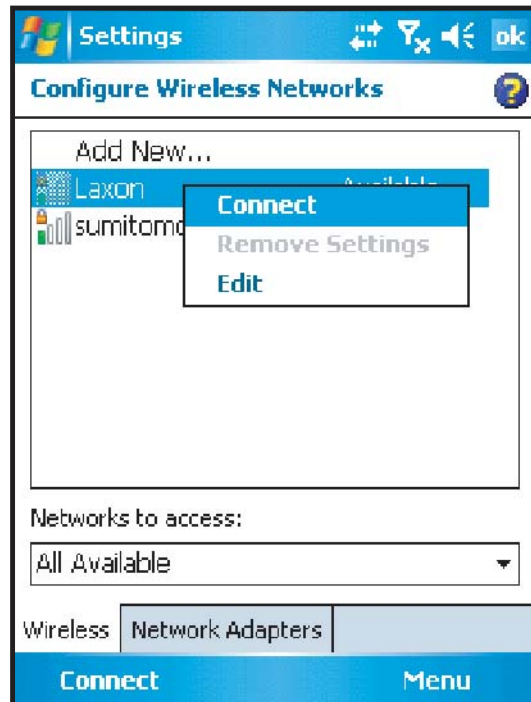

You will see a list of available access points. Tap and hold an available access point to bring up a menu. Tap **Connect**.

Entering Information

Your GPS Phone 600 offers several input methods:

Use the Soft Keyboard to enter typewritten characters. The Block Recognizer and Letter Recognizer render individual characters as “typed”. Transcriber converts handwritten words and symbols into typed characters.

The following screen shows the Keyboard input panel.

For more information on using Block Recognizer and Letter Recognizer, and demonstrations on writing characters, tap the question mark next to the writing area.

For more information on using Transcriber, tap the question mark on its command bar.

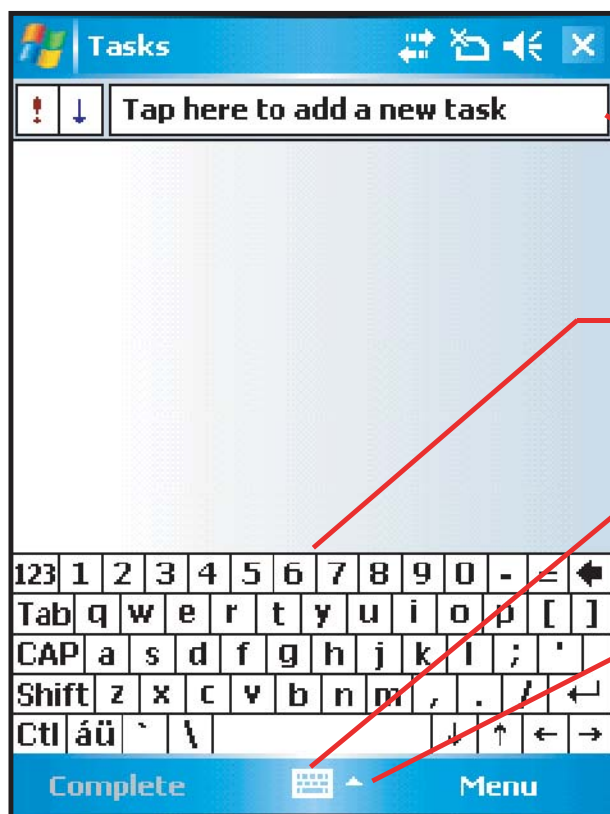

Tap a text box to display the current input panel, in this case, Keyboard.

To enter characters, tap them on the keyboard.

To open the selected input panel, tap the Input Panel button.

To select an input panel, tap the arrow, and then tap the input panel you want.

Starting Voice Commander

Tap  Start > Programs > Voice Commander, and then tap Voice Commander.

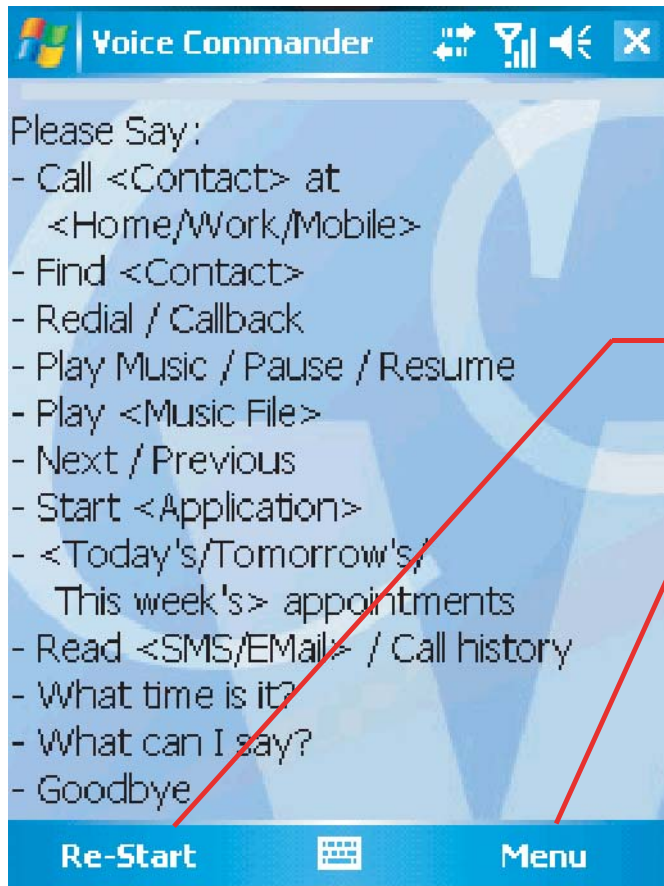

1. Show the format of voice command.

2. Re-Start Button:
Restart Voice Commander.

3. Menu Button:
Settings: Voice Commander Settings.
About: About Voice Commander.
Exit: Exit Voice Commander.

Need Help?

Last-minute updates, detailed technical information, news, and tips:

<http://www.microsoft.com/windowsmobile>

**Assistance using the Pharos Ostia navigation software with the
GPS Phone 600:**

<http://www.pharosgps.com>



www.pharosgps.com